

Gland Accessories

Brass & Aluminium Earth Tags



Features & Benefits

- > Ensures earth continuity is maintained between the gland and the equipment
- > Aluminium earth tags should be used with aluminium glands



Brass & Aluminium Earth Tags

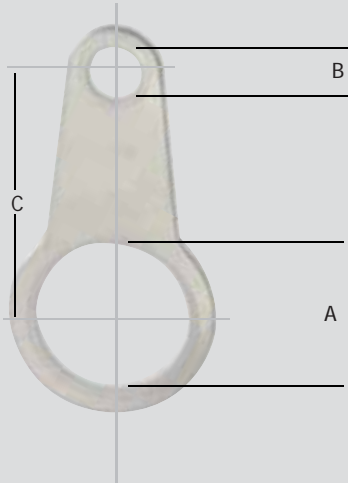

Gland Details

Design number		ISO entry thread diameter mm	Diameter A mm	Diameter B Bolt hole mm	Length C mm	Short Circuit Rating KA mm
Brass	Aluminium					
428ET-51	458ET51	16	16.3	6.7	24.5	1.8
428ET-53	458ET53	20	20.3	6.7	33.3	4.4
428ET-55	458ET55	25	25.8	6.7	35.8	4.0
428ET-56	458ET56	32	32.4	12.4	42.8	6.2
428ET-57	458ET57	40	40.4	13.2	45.3	9.8
428ET-59	458ET59	50	51.2	13.2	58.3	11.4
428ET-61	458ET61	63	63.9	13.2	65.3	12.0
428ET-63	458ET63	75	76.6	13.2	75.8	14.3
428ET-65	458ET65	85/90	90.7	13.2	80.3	-

NOTE:

1. Earth bond connections are specified in the IEE wiring regulations and relevant Codes of Practice.
If fault current rating of the cable exceeds the short circuit rating specified in the table above, an integral earth gland is recommended