

## BMHC240ADWB

Solid Blocked Straight Connector  
185-300 mm<sup>2</sup> Aluminium



**BI**con™

### Application

Power cables with aluminium conductors.  
Can be used with all jointing technologies:  
cold shrink, heat shrink, resin etc.

### Features

Profiled bores to enhance electrical contact and increase mechanical constraint.  
Full compliance with the **electrical** and **mechanical** requirements of IEC 61238.

# BMHC240ADWB Solid Blocked Straight Connector 185-300mm<sup>2</sup> Aluminium

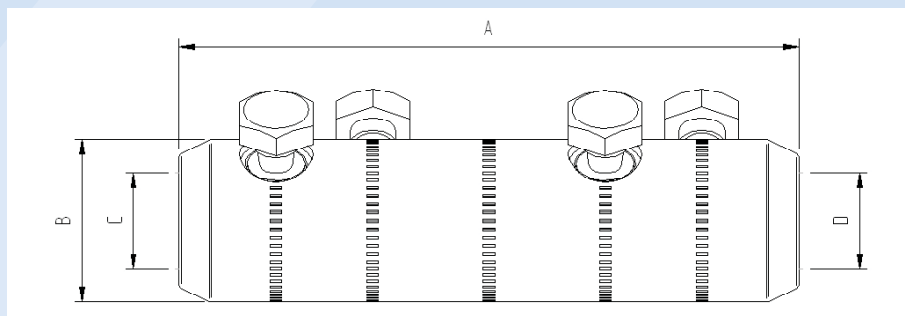

## Dimension Details

A	110 mm
B	35 mm
C	20 mm
D	20 mm

## Technical Data

Connector Type	Solid Blocked Straight
Material Reference Number	8705001
Catalogue Number	BMHC240ADWB
Connector Material	Aluminium
Number of Conductor Bolts	2+2
AF	19 mm
Shear torque	35-40 Nm
Bolt Material	Brass
Central Connection Type	None
Central Connection Bolt	N/A
AF	N/A mm
Shear Torque	N/A Nm
Bolt Material	N/A
Connection Bolt Removable	N/A
AF	N/A mm
Conductor Cross Section Range	
Solid Aluminium	185-300 mm <sup>2</sup>
Stranded Aluminium	185-240 mm <sup>2</sup>
Stranded Copper	N/A mm <sup>2</sup>
Stranded Flexible Copper	N/A mm <sup>2</sup>
Overall Length	110 mm
Diameter	35 mm
Weight (each)	375 g
Shipping Quantity (min)	20 pieces
Test Standard	IEC 61238

\*Technical Information subject to change without notice.

## Accessories

BMHOLDER	Connector brace for use on installation
59020	Mastic filler kit (Pack of 6 Strips)
8702302	Brass Centralising Range Extension Sleeve for 50mm <sup>2</sup> (Str Al/Cu) to 70mm <sup>2</sup> (SAC Al/Cu)
8702304	Brass Centralising Range Extension Sleeve for 10mm <sup>2</sup> (Str Al/Cu) to 35mm <sup>2</sup> (Str Al/Cu)