

BMHC500TCDSP

Solid Blocked Split Connector
400-500 mm²

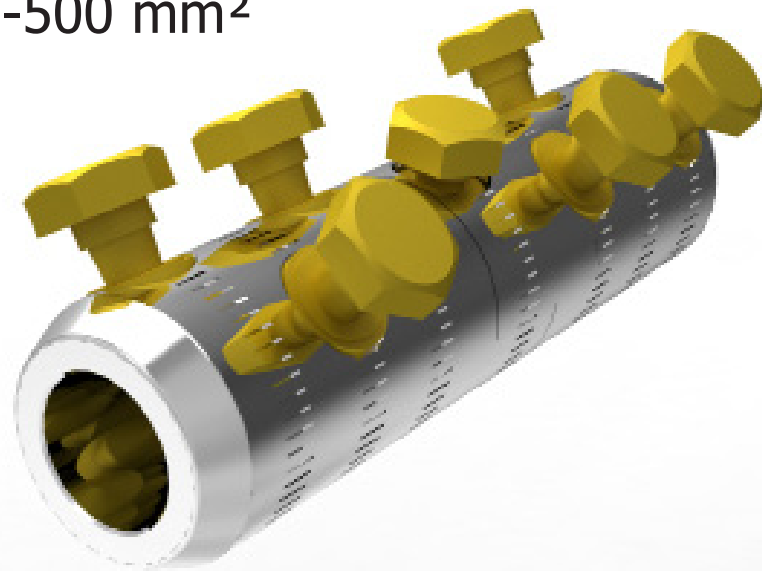

BIcon™

Application

Power cables with copper & aluminium conductors.

Can be used with all jointing technologies:

cold shrink, heat shrink, resin etc.

Features

High tensile Jigsaw centre split design.

Profiled bores to enhance electrical contact and increase mechanical constraint.

Full compliance with the **electrical** and **mechanical** requirements of IEC 61238.

CE

BMHC500TCDSP Solid Blocked Split Connector 400-500 mm²

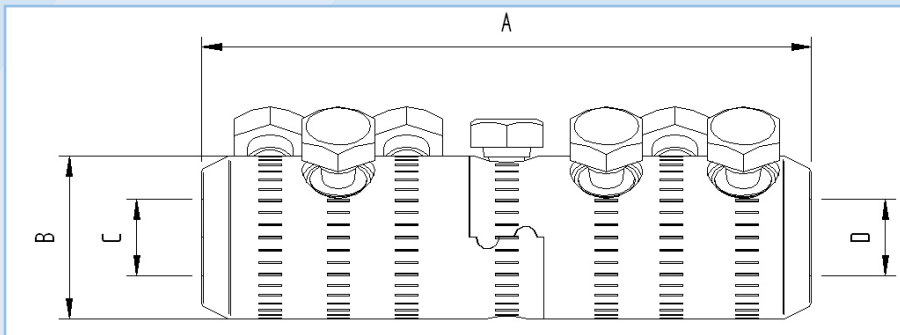

Dimension Details

A	180 mm
B	50 mm
C	30 mm
D	30 mm

Technical Data

Connector Type	Mechanical Split
Material Reference Number	8703501
Catalogue Number	BMHC500TCDSP
Connector Material	Tinned Copper
Number of Conductor Bolts	3+3
AF	19 mm
Shear torque	43-48 Nm
Bolt Material	Brass
Central Connection Type	Jigsaw
Central Connection Bolt	Yes, 1 off
AF	19 mm
Shear Torque	24 Nm
Bolt Material	Brass
Connection Bolt Removable	Yes, Allen Key
AF	6 mm
Conductor Cross Section Range	
Solid Aluminium	400-500 mm ²
Stranded Aluminium	400-500 mm ²
Stranded Copper	400-500 mm ²
Stranded Flexible Copper	N/A mm ²
Overall Length	180 mm
Diameter	50 mm
Weight (each)	2350 g
Shipping Quantity (min)	5 pieces
Test Standard	IEC 61238

*Technical Information subject to change without notice.

Accessories

BMHOLDER	Connector brace for use on installation
59020	Mastic filler kit (Pack of 6 Strips)
1873003	Central Connection Bolt (Pack of 1)
8703502	Brass Centralising Range Extension Sleeve for 185mm ² (Str Al/Cu)
8703507	Brass Centralising Range Extension Sleeve for 240mm ² (Str Al/Cu)
8703503	Brass Centralising Range Extension Sleeve for 300mm ² (Str Al/Cu)