

BMHC630TCDSP

Solid Blocked Split Connector
500-630 mm²

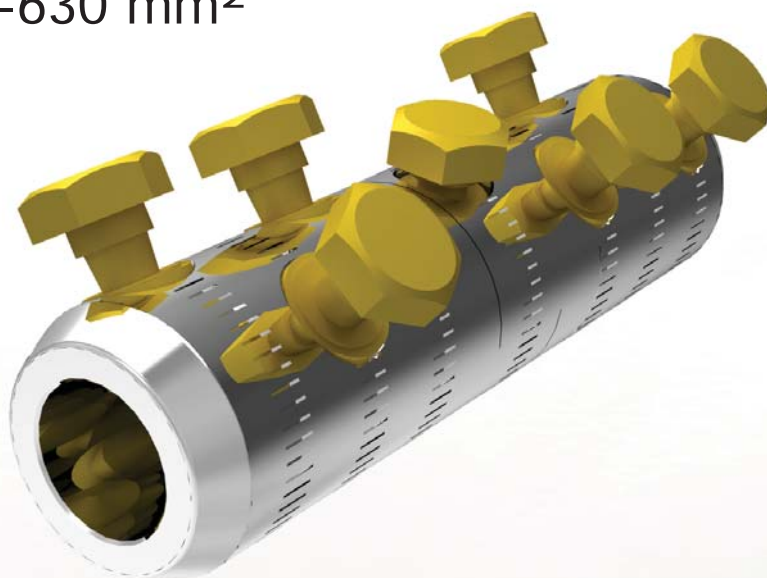

BI **CON**TM

Application

Power cables with copper & aluminium conductors.
Can be used with all jointing technologies:
cold shrink, heat shrink, resin etc.

Features

High tensile Jigsaw centre split design.
Profiled bores to enhance electrical contact and
increase mechanical constraint.
Full compliance with the **electrical** and **mechanical**
requirements of IEC 61238.

BMHC630TCDSP Solid Blocked Split Connector 500-630 mm²

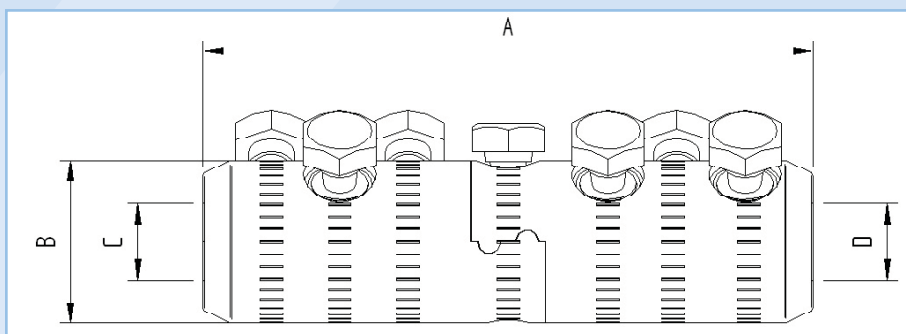

Dimension Details

A	180 mm
B	56 mm
C	36 mm
D	36 mm

Technical Data

Connector Type	Mechanical Split
Material Reference Number	8703504
Catalogue Number	BMHC630TCDSP
Connector Material	Tinned Copper
Number of Conductor Bolts	3+3
AF	19 mm
Shear torque	43-48 Nm
Bolt Material	Brass
Central Connection Type	Jigsaw
Central Connection Bolt	Yes, 1 off
AF	19 mm
Shear Torque	24 Nm
Bolt Material	Brass
Connection Bolt Removable	Yes, Allen Key
AF	6 mm
Conductor Cross Section Range	
Solid Aluminium	500-630 mm ²
Stranded Aluminium	500-630 mm ²
Stranded Copper	500-630 mm ²
Stranded Flexible Copper	N/A mm ²
Overall Length	180 mm
Diameter	50 mm
Weight (each)	2790 g
Shipping Quantity (min)	4 pieces
Test Standard	IEC 61238

*Technical Information subject to change without notice.

Accessories

BMHOLDER	Connector brace for use on installation
59020	Mastic filler kit (Pack of 6 Strips)
1873103	Central Connection Bolt (Pack of 1)
8703505	Brass Centralising Range Extension Sleeve for 240mm ² (Str Al/Cu)
8703506	Brass Centralising Range Extension Sleeve for 300-400mm ² (Str Al/Cu)