

BMHC95ADSP

Solid Blocked Split Connector
50-95 mm²



BI **CON**™

Application

Power cables with aluminium conductors.
Can be used with all jointing technologies:
cold shrink, heat shrink, resin etc.

Features

High tensile Jigsaw centre split design.
Profiled bores to enhance electrical contact and
increase mechanical constraint.
Full compliance with the **electrical** and **mechanical**
requirements of IEC 61238.

BMHC95ADSP Solid Blocked Split Connector 50-95 mm²

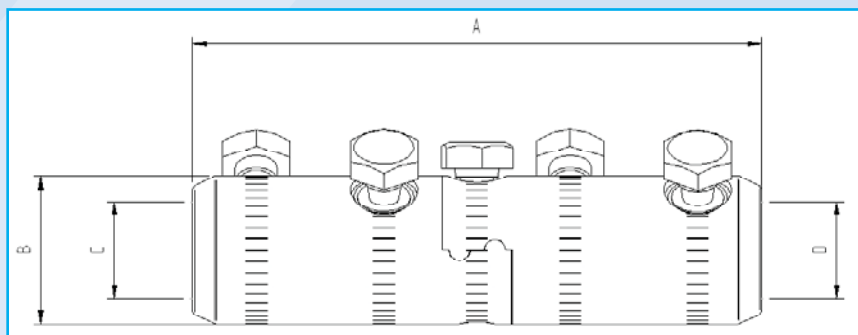

Dimension Details

A	111 mm
B	28 mm
C	14 mm
D	14 mm

Technical Data

Connector Type	Mechanical Split
Material Reference Number	8702804
Catalogue Number	BMHC95ADSP
Connector Material	Aluminium
Number of Conductor Bolts	2+2
AF	17 mm
Shear torque	27-32 Nm
Bolt Material	Brass
Central Connection Type	Jigsaw
Central Connection Bolt	Yes, 1 off
AF	17 mm
Shear Torque	24 Nm
Bolt Material	Brass
Connection Bolt Removable	Yes, Allen Key
AF	6 mm
Conductor Cross Section Range	
Solid Aluminium	50-95 mm ²
Stranded Aluminium	50-95 mm ²
Stranded Copper	N/A mm ²
Stranded Flexible Copper	N/A mm ²
Overall Length	111 mm
Diameter	28 mm
Weight (each)	280g
Shipping Quantity (min)	20 pieces
Test Standard	IEC 61238

*Technical Information subject to change without notice.

Accessories

BMHOLDER	Connector brace for use on installation
59020	Mastic filler kit (Pack of 6 Strips)
8702802	Brass Centralising Range Extension Sleeve for 10mm ² (Str Al/Cu) to 35mm ²
8702803	Central Connection Bolt (Pack of 3)