

BMHC400TADWB

Solid Blocked Straight Connector
185-400 mm²



BI **CON**TM

Application

Power cables with copper and aluminium conductors.
Can be used with all jointing technologies:
cold shrink, heat shrink, resin etc.

Features

Tin plated aluminium connector body allowing good electrical connection with copper and aluminium conductors with minimal bi-metallic effect.
Profiled bores to enhance electrical contact and increase mechanical constraint.
Full compliance with the **electrical** and **mechanical** requirements of IEC 61238.

BMHC400TADWB Solid Blocked Straight Connector 185-400 mm²

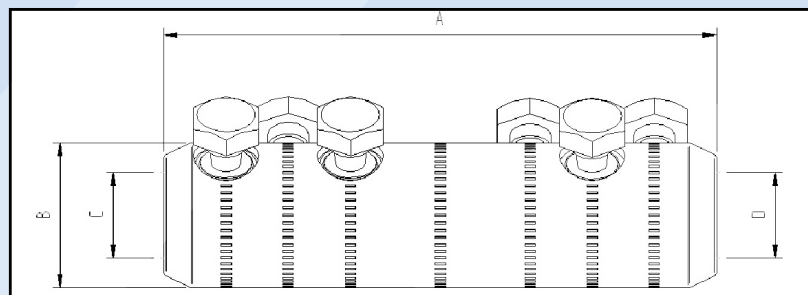

Dimension Details

A	150 mm
B	42 mm
C	27.5 mm
D	27.5 mm

Technical Data

Connector Type	Solid Blocked Straight
Material Reference Number	8707001
Catalogue Number	BMHC400TADWB
Connector Material	Tinned Aluminium
Number of Conductor Bolts	3+3
AF	19 mm
Shear torque	43-47 Nm
Bolt Material	Brass
Central Connection Type	None
Central Connection Bolt	None
AF	N/A
Shear Torque	N/A
Bolt Material	N/A
Connection Bolt Removable	
AF	N/A
Conductor Cross Section Range	
Solid Aluminium	240-400 mm ²
Stranded Aluminium	185-400 mm ²
Stranded Copper	185-400 mm ²
Stranded Flexible Copper	240-400 mm ²
Overall Length	150 mm
Diameter	42 mm
Weight (each)	670g
Shipping Quantity (min)	20 pieces
Test Standard	IEC 61238

*Technical Information subject to change without notice.

Accessories

BMHOLDER	Connector brace for use on installation
59020	Mastic filler kit (Pack of 6 Strips)