

MECH GLAND FOR PRE-CONNECTORISED CABLES

**THIS GUIDE CAN ONLY BE USED IN CONJUNCTION WITH THE
PRECONNECTORISED CMJ/MMJ CLOSURES.**

DESCRIPTION

The mechanical gland for pre-connectorised closures details how a gland is assembled with cables then into a closure.
It details a single way entry gland as well as multi way glands for cable sizes.

TOOLS REQUIRED

Tbc
Gland spanner (optional)

CONTENTS

1. Removal of pre-fitted port blanks
2. Gland assembly
 - Single way
 - 2 way
 - 4 way
 - 8 way
3. Assembling a gland into a closure
4. Adding a cable to a pre-installed gland
 - 2 way
 - 4 way
 - 8 way
5. Removal of a gland from a closure

INSTALLATION INSTRUCTION

PART NUMBERS – XJTSC03631 – SINGLE WAY 7-11mm SPLIT
XJTSC03632 – 2 WAY 5-7mm SPLIT
XJTSC03633 – 4 WAY 3-5mm SPLIT
XJTSC03634 – 8 WAY 3-5mm SPLIT

KIT CONTENTS

ITEM No.:	DESCRIPTION	QTY
1	MEDIUM BODY SEALING GLAND	x1
2	MEDIUM NUT	x1
3	O-RING BS124 NITRILE	x2
4	CABLE TIES	1 PER ENTRY
6	8 WAY GLAND ATTACHMENT	x1
7	SPLIT CABLE SEAL (SINGLE WAY, 2 WAY, 4 WAY OR 8 WAY)	x1
8	TORSION PIECE	x1
9	BLANKS	x1
10	GREASE SACHET	x1



1.0 REMOVAL OF PRE-FITTED PORT BLANKS

Step 1

SELECT THE APPROPRIATE PORT TO BE USED.

REMOVE PORT BLANK FROM BASE BY FULLY SQUEEZING TOGETHER THE TABS FROM INSIDE THE BASE.

NOTE: YOU MAY NEED TO ROTATE THE BLANK IN THE PORT TO SQUEEZE THE TABS.

USING YOUR OTHER HAND OR PLIERS, HOLD THE CENTRAL RIB AND FIRMLY PULL UNTIL THE PORT BLANK IS RELEASED.



2.0 GLAND ASSEMBLY

Step 2

Thread the gland components over the preconnectorised cable in the order and orientation as shown below.

NOTE: for the 8way gland 3mm cables should use the smaller Torsion piece in the kit, all other cables should use the larger torsion piece.

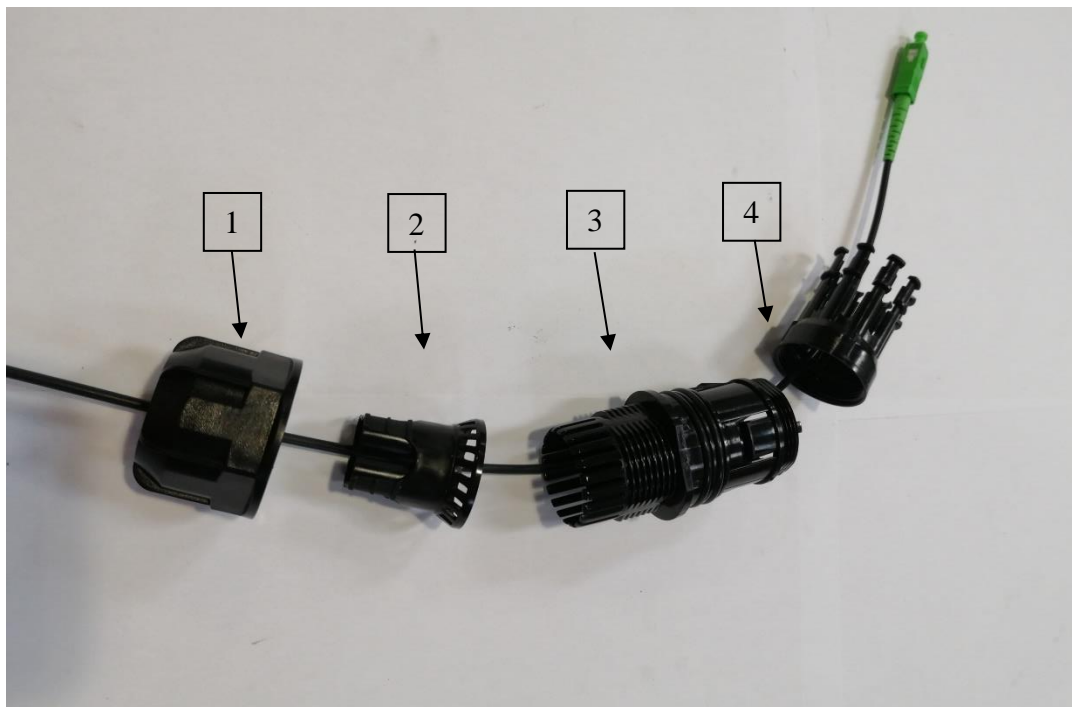

MECH SEAL – 4 WAY GLAND INSTALLATION GUIDE

Step 3

Snap the split seal around the cable, keep as shown and push into the back of the gland body.

Repeat for the number of cables being installed.

NOTE: the different cable lengths depending on closure being used.

Ensure the protrusion on the seal is facing out of the gland.

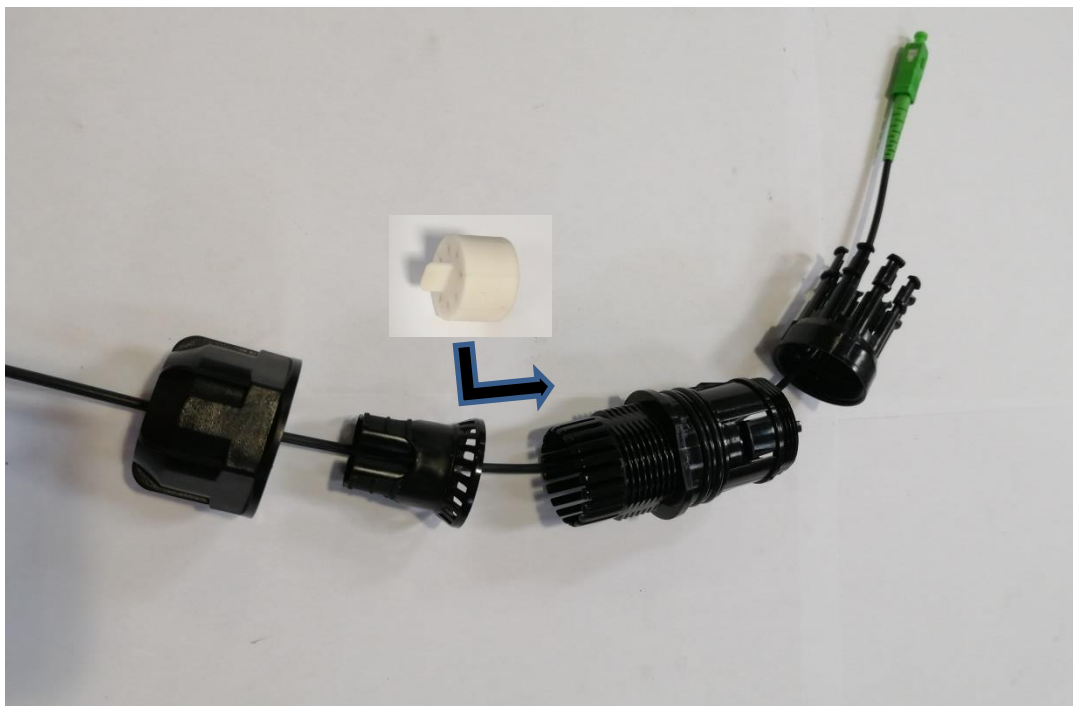

MECH SEAL – 4 WAY GLAND INSTALLATION GUIDE

Step 4

Slide the torsion piece and the nut onto the cable gland body.

Note: Make sure any unused holes have blank plugs, which should be inserted from the top of the nut.

Note: Do not put the cable ties on before you install the gland into the closure.

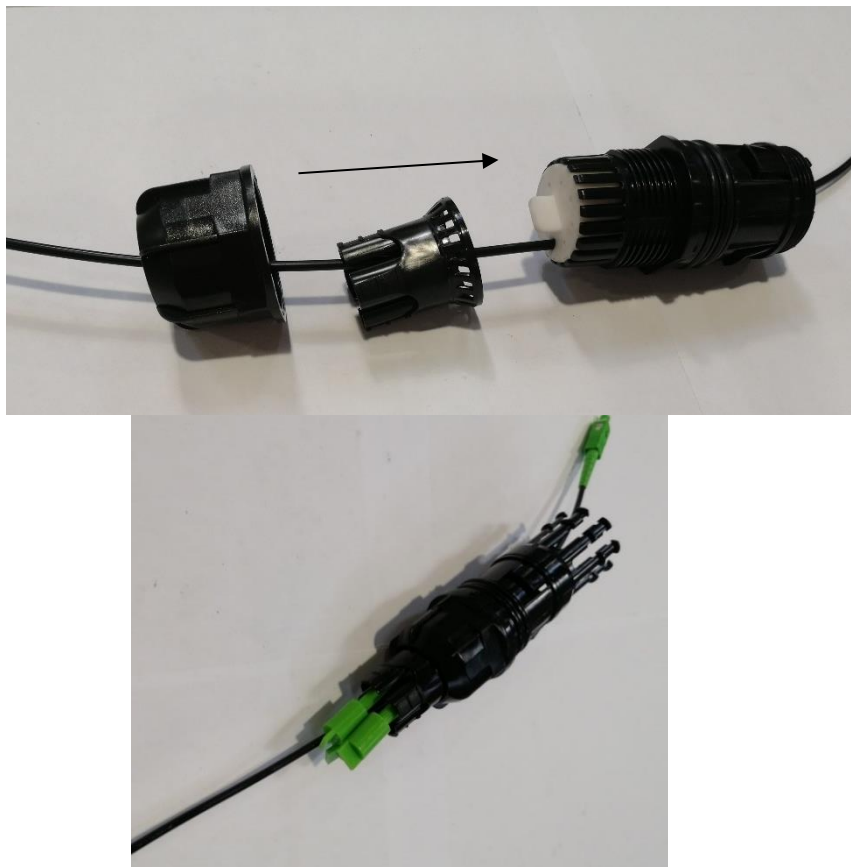

INSTALLING THE GLAND INTO THE CLOSURE

Step 5

Push gland into the Preconnectorised CMJ base. Once resistance on O-ring is felt, continue pushing with a twisting action until an audible click is heard. Visually check from inside the base all 3 clips are secured into base.

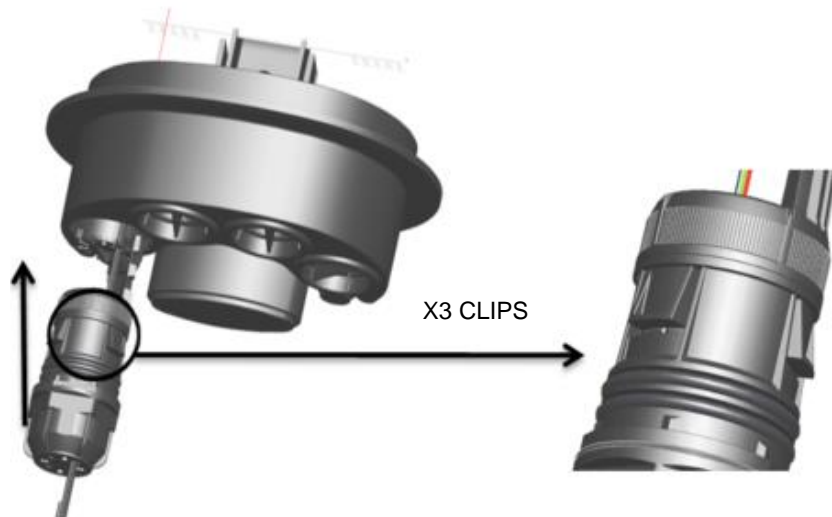

INSTALLING THE GLAND INTO THE CLOSURE

Step 6

Make sure you have enough cable to plug the connector into the adapter.

If not, untighten the nut, adjust the cable length by gently pulling the cable and tighten the nut back up.



INSTALLING THE GLAND INTO THE CLOSURE

Step 7

Attach the cable ties around the cables, one cable per up stand.

Cut off any excess length of cable tie.



INSTALLING THE GLAND INTO THE CLOSURE

Step 8

Push the connector into the required adapter following the label on the manifold cover.

Go to step 13 if installs are complete.

Check IP586 section 2 to select correct adapter position



ADDING A DROP CABLE TO AN EXISTING GLAND

Step 9

Unscrew the nut, make sure you do not twist the seal, keep the existing cable straight and start by pulling all the blank plugs out and seal out using protrusion.

Set blank plugs aside.

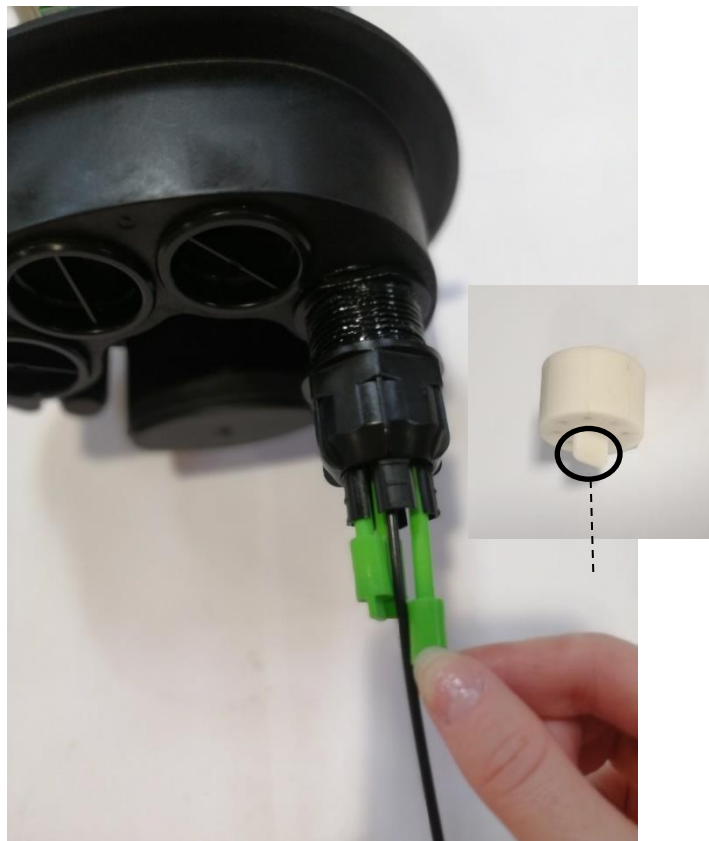

ADDING A DROP CABLE TO AN EXISTING GLAND

Step 10

Follow steps 3 and 4 for adding the second cable into the gland.

Adjust the cable length as described in step 6.



ADDING A DROP CABLE TO AN EXISTING GLAND

Step 11

Follow step 7 for attaching the cable tie around the cable.



ADDING A DROP CABLE TO AN EXISTING GLAND

Step 12

Push the connector into the required adapter.

Check IP586 section 2 to select correct adapter position

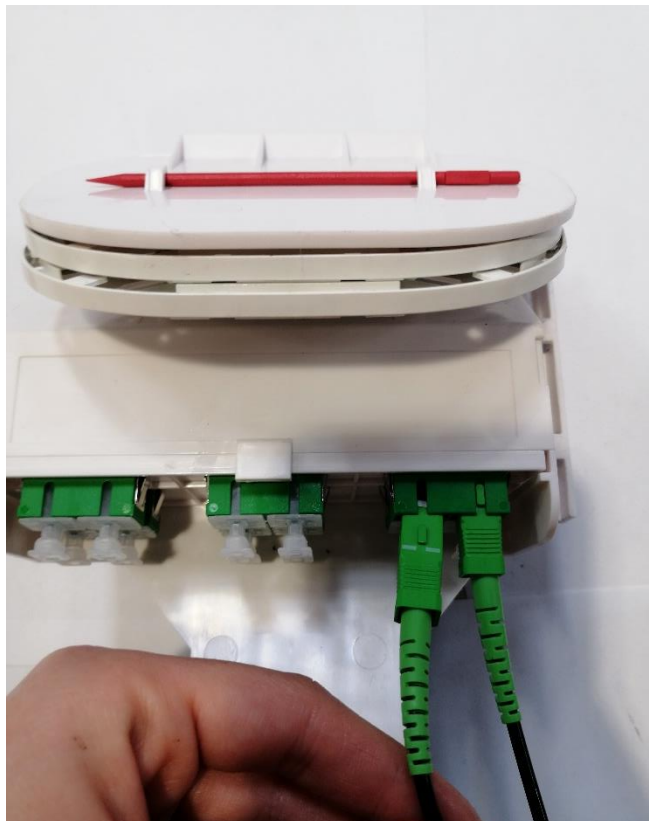

JOINT CLOSEDOWN

Step 13



- Ensure that the ‘O’ seal and adjacent surfaces of the base and cap are clean. Lower the cap onto the base.
- Assemble the clamp around the base.

JOINT CLOSEDOWN

Step 14

Push the toggle arm
to lock the clamp



- Squeeze the clamp together and engage the toggle arm. Push the toggle arm into the clamp to lock and seal.

Closure is closed down